

**Lot 28, 10170 120 Avenue  
Grande Prairie, Alberta**

**MLS # A2030626**

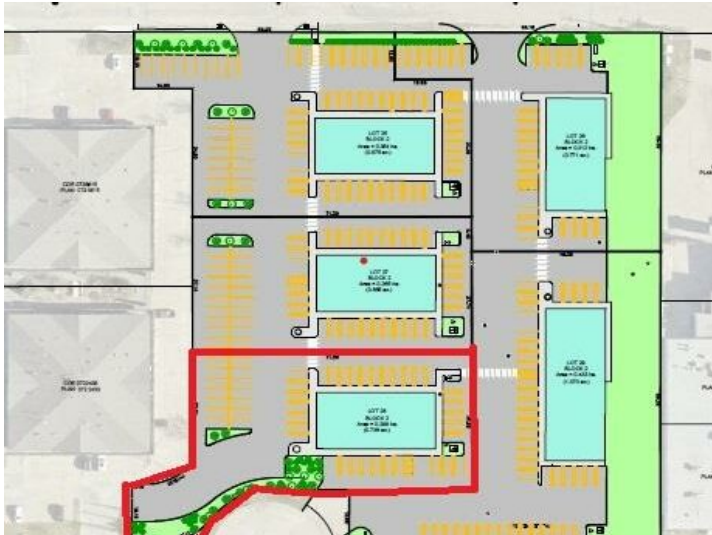

**\$503,116**

**Division:** Northridge

**Lot Size:** 0.74 Acre

**Lot Feat:** -

**By Town:** -

**LLD:** -

**Zoning:** CA

**Water:** -

**Sewer:** -

**Utilities:** -

Lot 28 - Think you want your own commercial building? Don't want the hassle of buying the land, getting the services installed, prepping the base and paving? Northridge Business Center is for you!! Established business center. Five lots to choose from. All the paving is done. Services are in. And there is a 5,000 square foot building pad on each lot, ready for your building. Lot 28 is \$503,116.15, plus services and roads \$268,953.07, for a total of \$772,069.22, plus GST. It doesn't get simpler than that!!!